

PROPOSED LANDUSE MAP

Sambalpur Development Authority (SDA)

Mouza: Tilaimal; P.S. : Katarbaga No. : 30 (6/6)

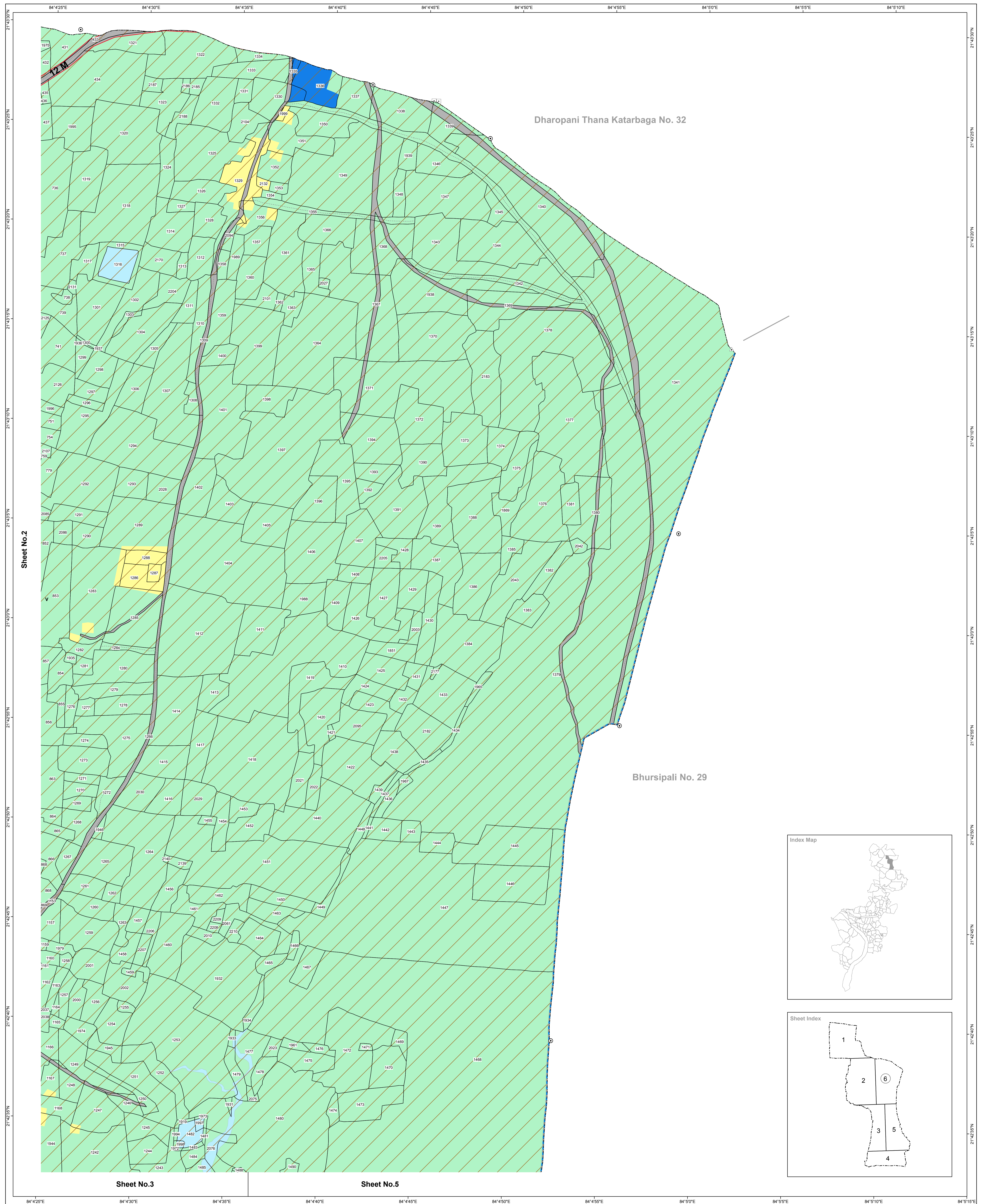
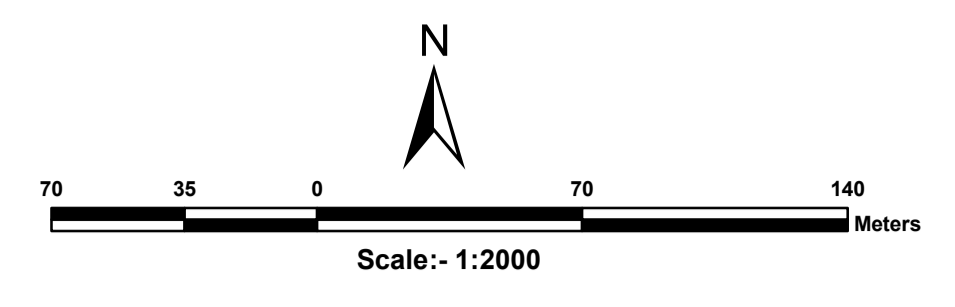

Dharopani Thana Katarbaga No. 32

Bhursipali No. 29

Sheet No.2

Sheet No.3

Sheet No.5

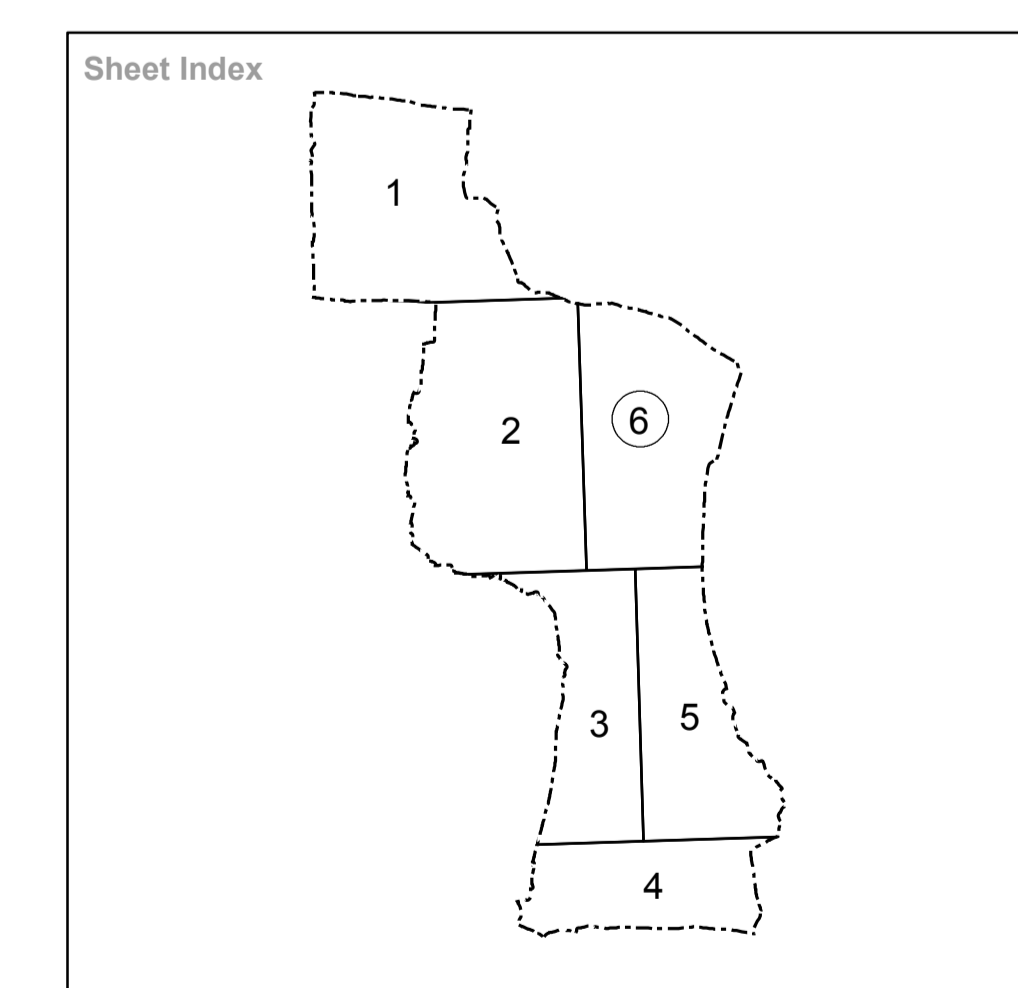
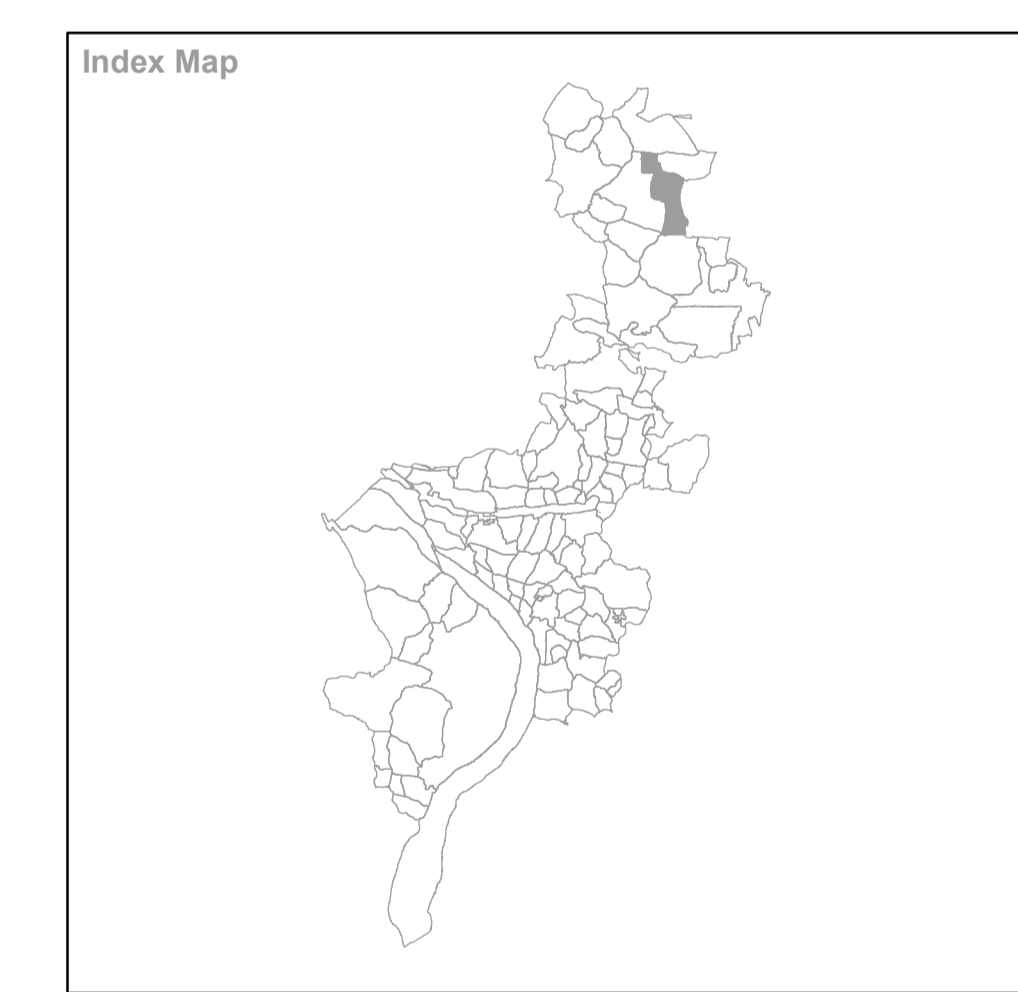

<ul style="list-style-type: none"> Residential Use Zone Retail Business Neighbourhood Shopping Use Zone Wholesale Warehousing and Storage Use Zone Industrial (Light Manufacturing Industry, Service Industry and Medium Industry) Use Zone Public Semi Public Use Zone Utilities and Services Recreation (and open space) Use Zone Transportation Use Zone Special Area Use Zone 	<ul style="list-style-type: none"> Agricultural (and Allied) Use Zone Water bodies Use Zone Area : water supply scheme to be introduced in future Land for Rehabilitation of Slum Dwellers existing on Nala Bank Old builtup area (Buildings of historical or architectural or archaeological importance described in the draft C.D.P.Report.) Existing Road Proposed Road Proposed Bridge over River Mahanadi Fly Over Bridge 	<ul style="list-style-type: none"> Railway Line / Railway Station (RS) Existing Water Supply Rising main 1000 mm Existing Water Supply Main distribution line 300 mm Natural Drainage Channel / Waste Water with realignment (Dhobijore and Tangra Nalas in dotted line - 3 feet deep stone pitching inside and 15 feet wide stone walk way with 50 feet c to c trees / Street lights in developed Urban area) Comprehensive Development Plan (SDA) Boundary Municipal Boundary Mouza Boundary Zone Boundary Ward Boundary Revenue Settlement Boundary 	<ul style="list-style-type: none"> Village Road Plot Boundary Dosimali Trisimali Mustakilchand Railway Pillar/Other Pillar
--	---	---	--

Village Name : Tilaimal
Sheet No.6

Tahasil Name : Rengali

Source/ Database Used :
 Data Used For Preparing Existing Landuse
 Satellite Data : World View-1 (PAN)
 Cadastral Data : Year-1975-76
 Ground Truthing : August 2010

Guideline :
 Directorate of Town Planning
 Deptt. of Housing & Urban Development
 Govt. of Orissa

Prepared by :
Gujarat Industrial and Technical Consultancy Organisation, Ahmedabad

Sambalpur Development Authority, Sambalpur