

PROPOSED LANDUSE MAP

Sambalpur Development Authority (SDA)

Mouza: Tilaimal; P.S. : Katarbaga No.30 (3/6)

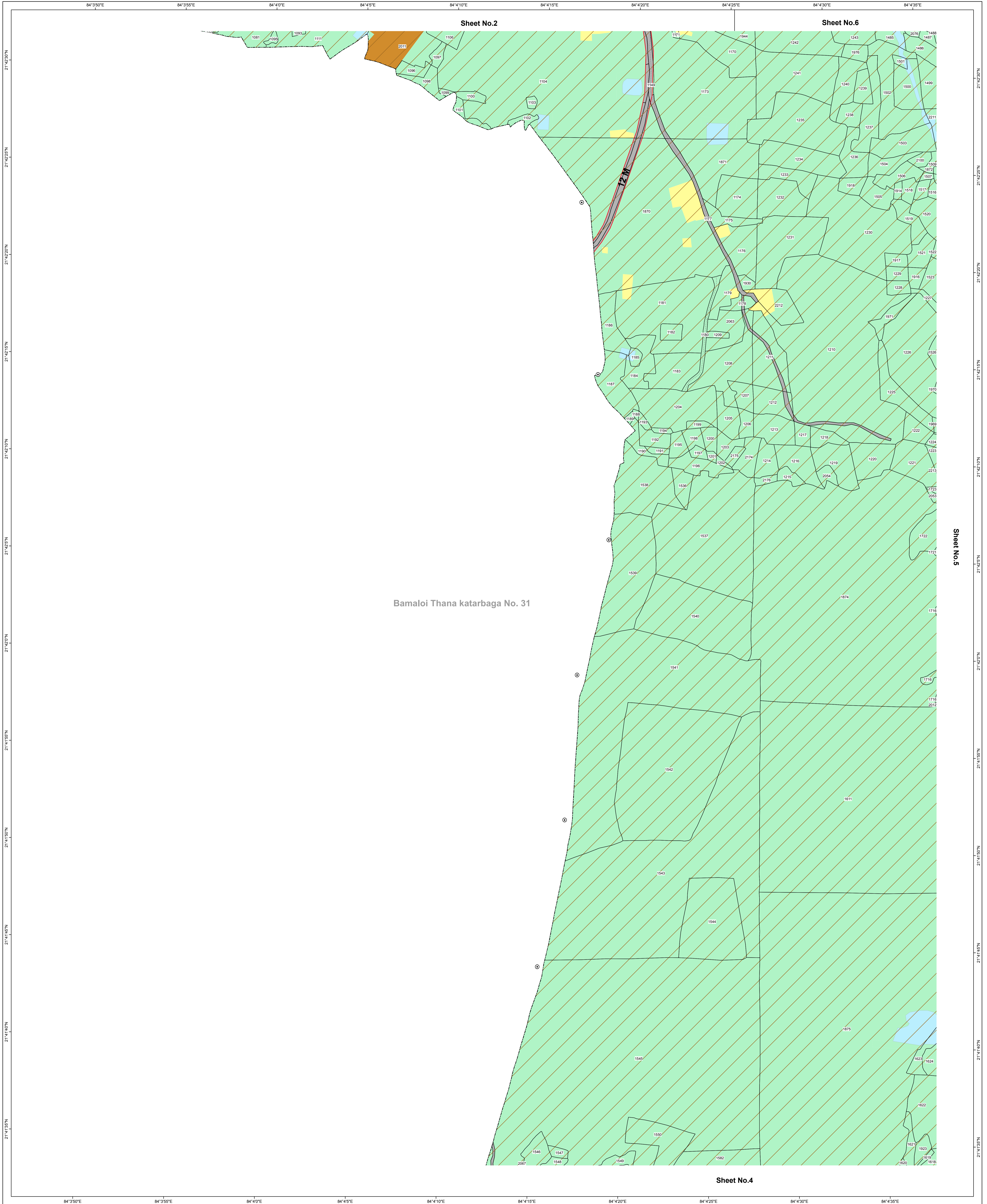
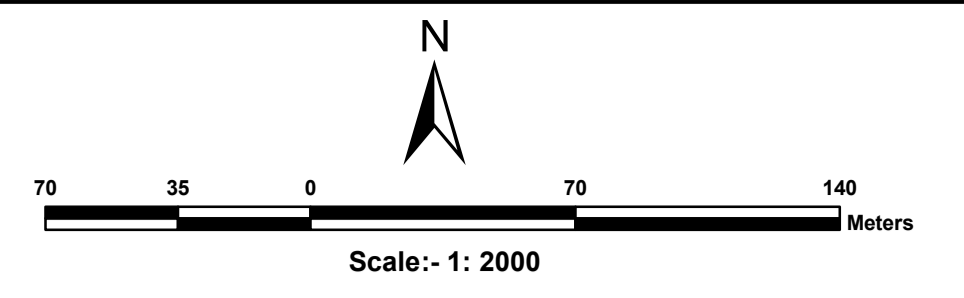

- | | |
|--|---|
| Residential Use Zone | Agricultural (and Allied) Use Zone |
| Retail Business Neighbourhood Shopping Use Zone | Water bodies Use Zone |
| Wholesale Warehousing and Storage Use Zone | Area : water supply scheme to be introduced in future |
| Industrial (Light Manufacturing Industry, Service Industry and Medium Industry) Use Zone | Land for Rehabilitation of Slum Dwellers existing on Nala Bank |
| Public Semi Public Use Zone | Old builtup area (Buildings of historical or archaeological importance described in the draft C.D.P.Report) |
| Utilities and Services | Existing Road |
| Recreation (and open space) Use Zone | Proposed Road |
| Transportation Use Zone | Proposed Bridge over River Mahanadi |
| Special Area Use Zone | Fly Over Bridge |

- | | |
|--|-----------------------------|
| Railway Line / Railway Station (RS) | Village Road |
| Existing Water Supply Rising main 1000 mm | Plot Boundary |
| Existing Water Supply Main distribution line 300 mm | Dosimali |
| Natural Drainage Channel / Waste Water with realignment (Dhobijore and Tangra Nalas in dotted line - 3 feet deep stone pitching inside and 15 feet wide stone walk way with 50 feet c to c trees / Street lights in developed Urban area) | Trisimali |
| Comprehensive Development Plan (SDA) Boundary | Mustakichand |
| Municipal Boundary | Railway Pillar/Other Pillar |
| Mouza Boundary | |
| Zone Boundary | |
| Ward Boundary | |
| Revenue Settlement Boundary | |

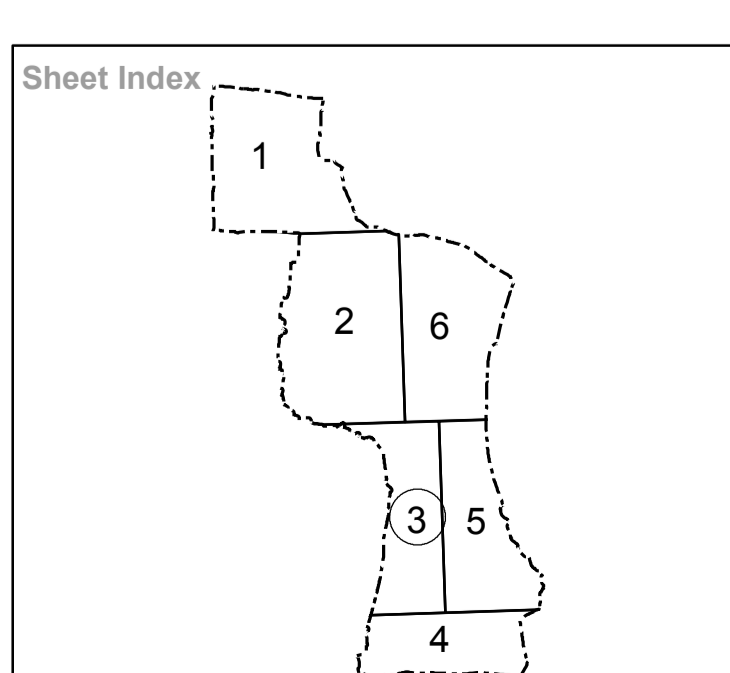
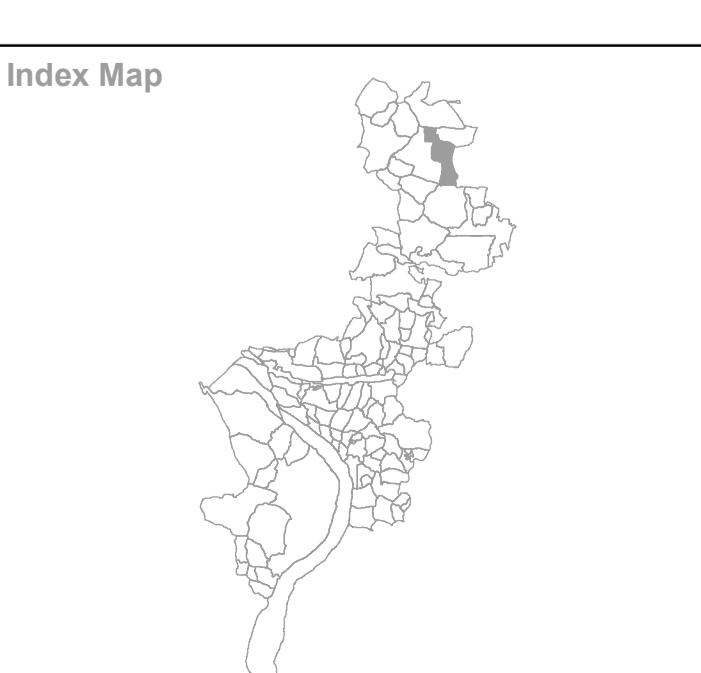

Village Name : Tilaimal
Sheet No.3

Tahasil Name : Rengali

Source Database Used :
Data Used For Preparing Existing Landuse
Satellite Data : World View-1 (PAN)
Cadastral Data : Year-1975-76
Ground Truthing : August 2010

Guideline :

Directorate of Town Planning
Deptt. of Housing & Urban Development
Govt. of Orissa

Prepared by :
 Gujarat Industrial and Technical Consultancy Organisation, Ahmedabad

Sambalpur Development Authority, Sambalpur