

PROPOSED LANDUSE MAP Sambalpur Development Authority (SDA)

Mouza: Talaba; P.S. : Sasan No. 4 (1/8)

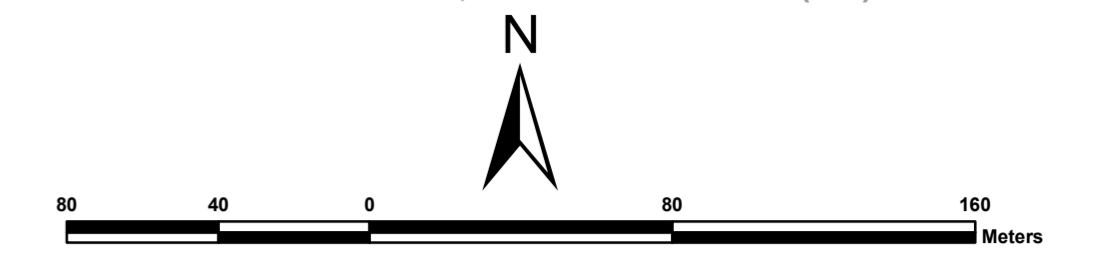

L E G E N D

- Residential Use Zone
- Retail Business Neighbourhood Shopping Use Zone
- Wholesale Warehousing and Storage Use Zone
- Industrial (Light Manufacturing Industry, Service Industry and Medium Industry) Use Zone
- Public Semi Public Use Zone
- Utilities and Services
- Recreation (and open space) Use Zone
- Transportation Use Zone
- Special Area Use Zone
- Agricultural (and Allied) Use Zone
- Water bodies Use Zone
- Area : water supply scheme to be introduced in future
- Land for Rehabilitation of Slum Dwellers existing on Nala Bank
- Old builtup area (Buildings of historical or architectural or archaeological importance described in the draft C.D.P.Report.)
- Existing Road
- Proposed Road
- Proposed Bridge over River Mahanadi
- Fly Over Bridge
- Railway Line / Railway Station (RS)
- Existing Water Supply Rising main 1000 mm
- Existing Water Supply Main distribution line 300 mm
- Natural Drainage Channel / Waste Water with realignment (Dhobijore and Tangra Nalas in dotted line - 3 feet deep stone pitching inside and 15 feet wide stone walk way with 50 feet c to c trees / Street lights in developed Urban area)
- Comprehensive Development Plan (SDA) Boundary
- Municipal Boundary
- Mouza Boundary
- Zone Boundary
- Ward Boundary
- Revenue Settlement Boundary
- Village Road
- Plot Boundary
- Dosimali
- Trisimali
- Mustakilchand
- Railway Pillar/Other Pillar

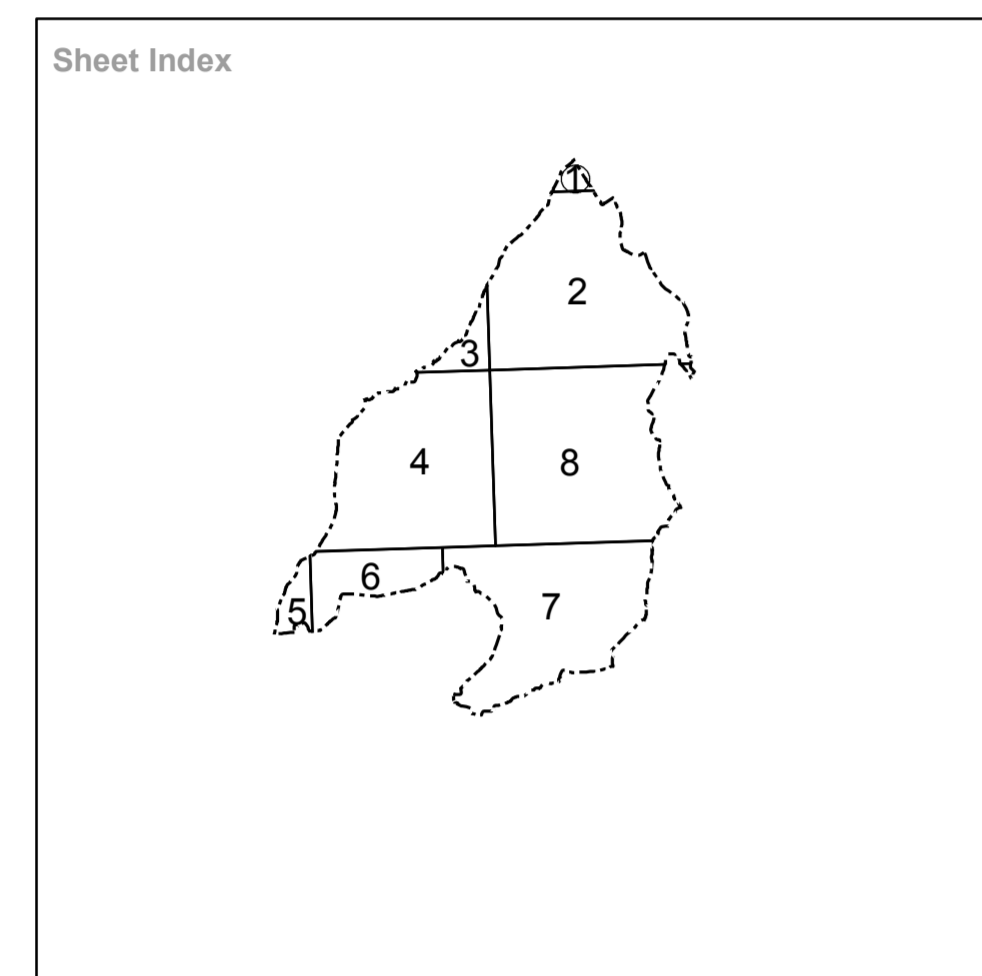
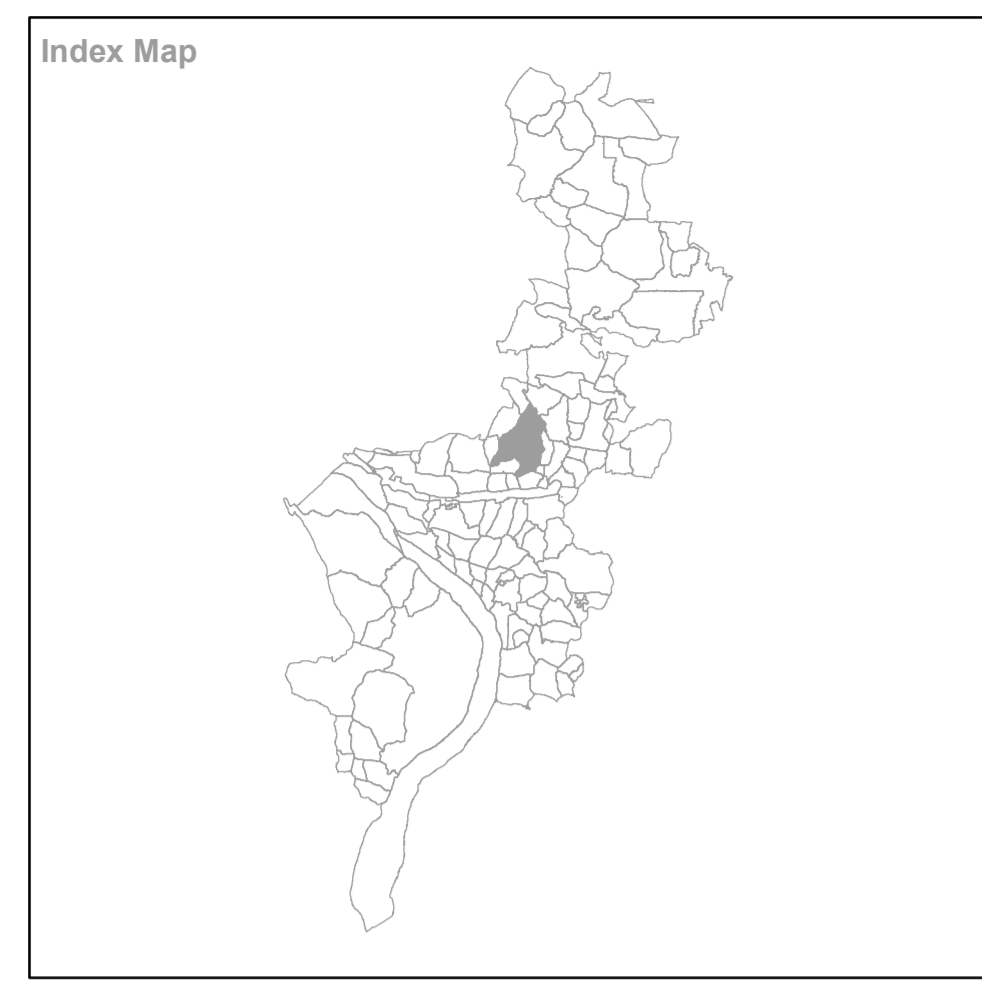

Gaurpali Thana Sasan No. 3

Sangulpali Thana Sasan No. 19

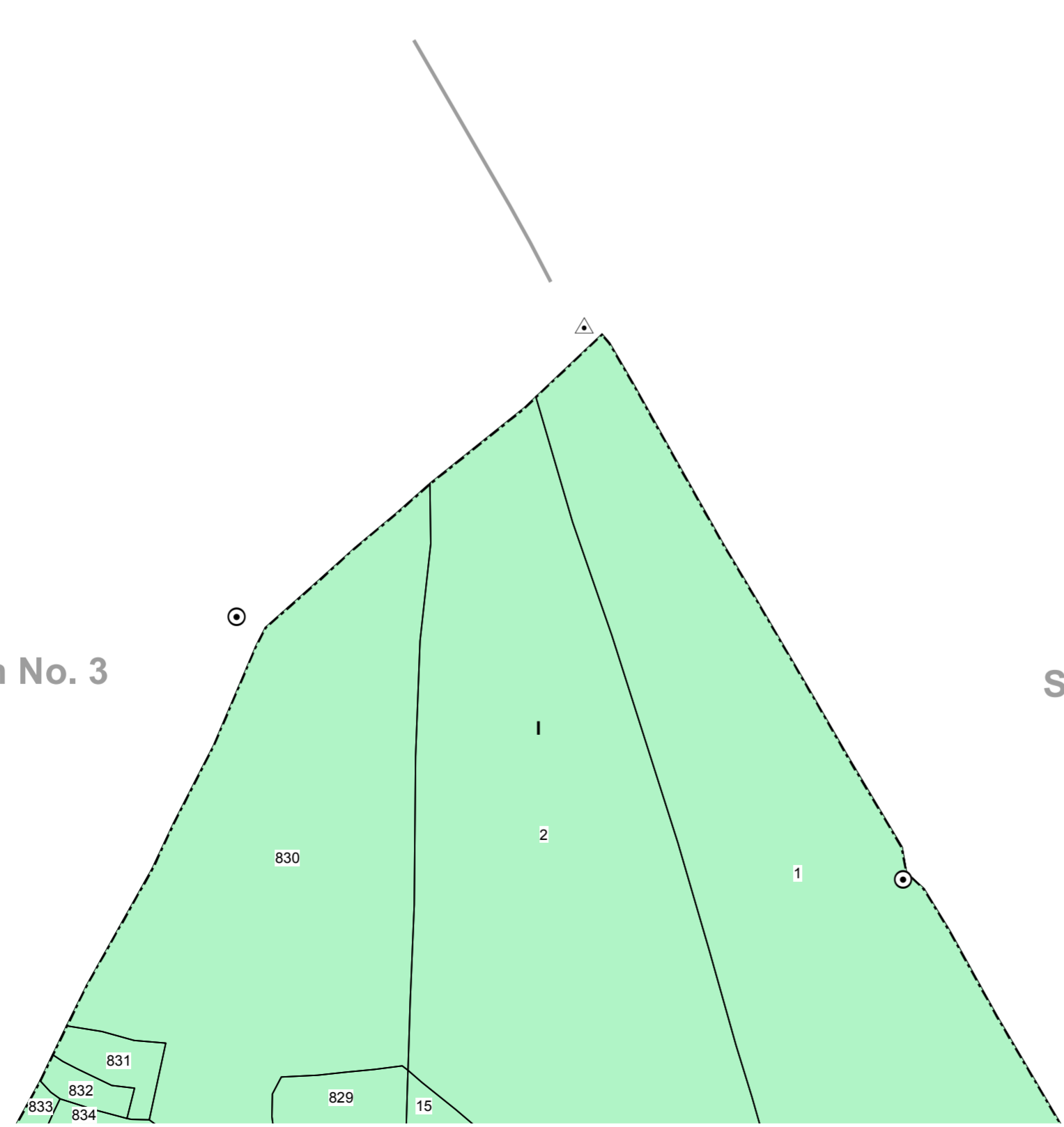

Sheet No. 2

Source/ Database Used :
Data Used For Preparing Existing Landuse

Satellite Data : World View-I (PAN)
Cadastral Data : Year-1970-71
Ground Truthing : August 2010

Village Name : Talaba
Sheet No. 1

Tahasil Name : Rengali

Guideline : Urban GIS Database Development for CDP/ Master Plan Preparation



Directorate of Town Planning
Deptt. of Housing & Urban Development
Govt. of Orissa

Prepared by :



Gujarat Industrial and
Technical Consultancy
Organisation, Ahmedabad



Sambalpur Development
Authority, Sambalpur