

# PROPOSED LANDUSE MAP

## Sambalpur Development Authority (SDA)

Mouza: Bamaloi; P.S. : Katarbaga No. 31 (3/10)

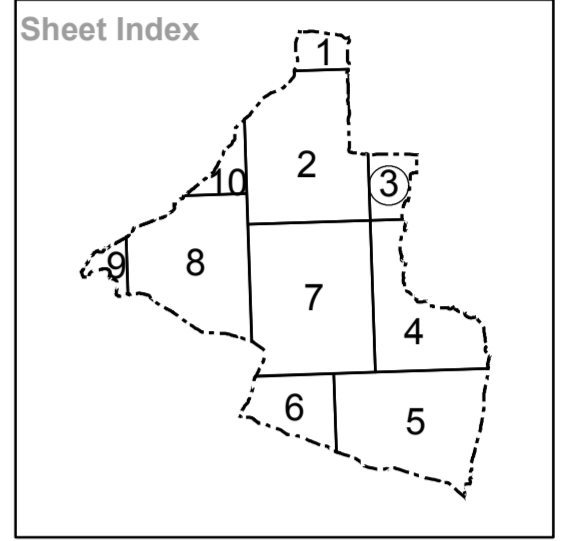
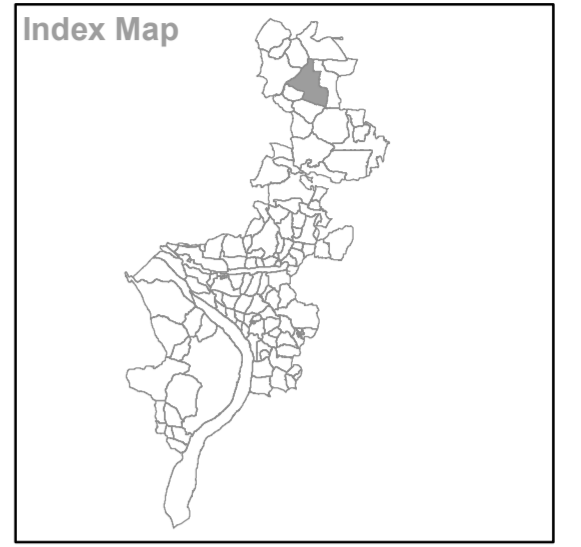
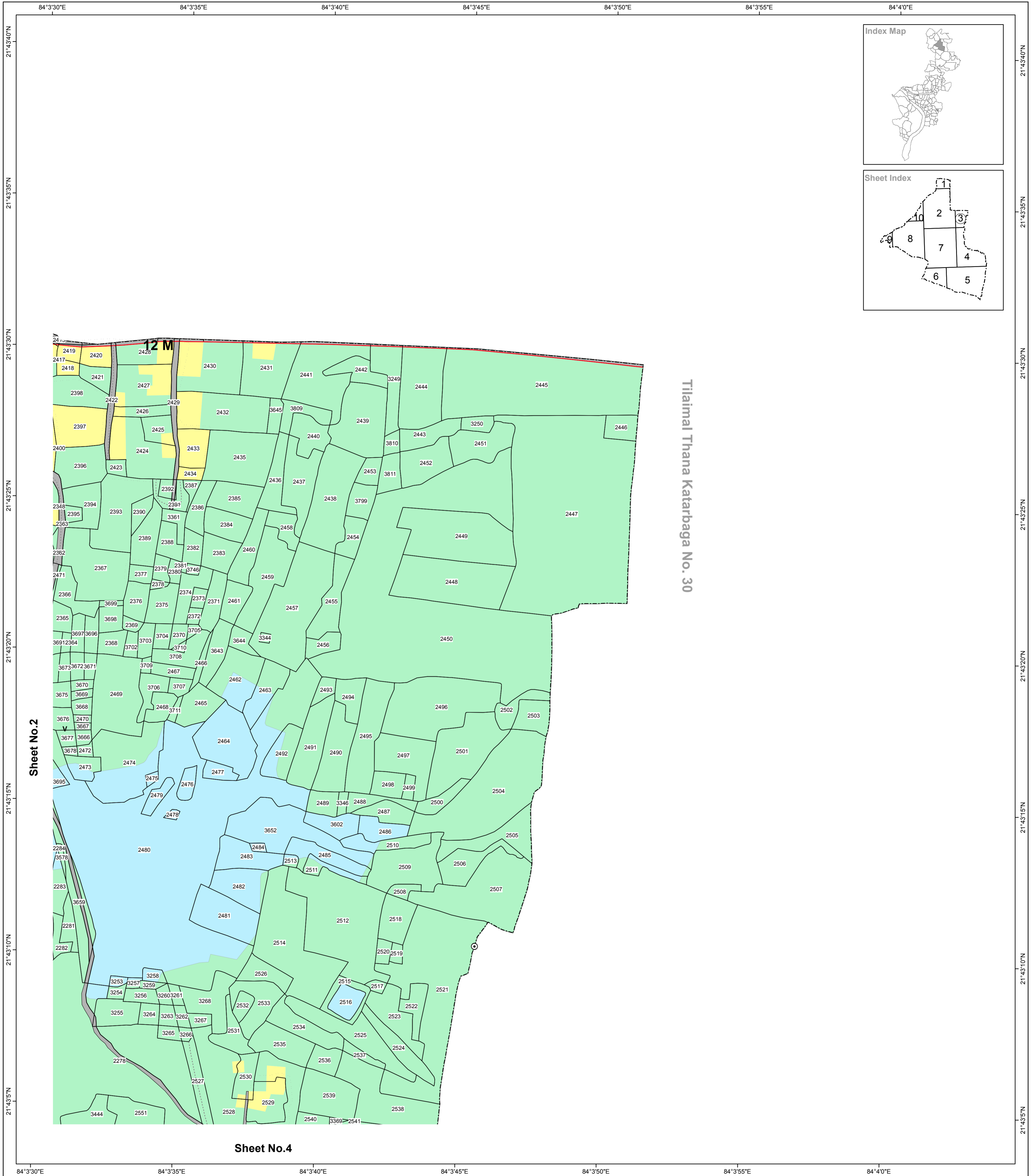
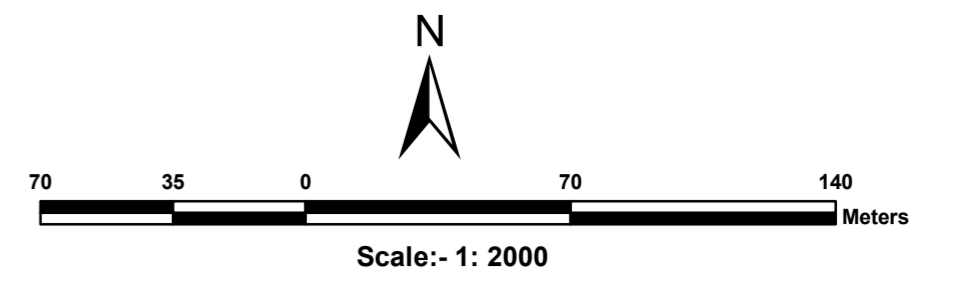

- |  |   |   |                             |
|--|---|---|-----------------------------|
| Residential Use Zone   | Agricultural (and Allied) Use Zone  | Railway Line / Railway Station (RS)   | Village Road                |
| Retail Business Neighbourhood Shopping Use Zone  | Water bodies Use Zone   | Existing Water Supply Rising main 1000 mm   | Plot Boundary               |
| Wholesale Warehousing and Storage Use Zone   | Area : water supply scheme to be introduced in future   | Existing Water Supply Main distribution line 300 mm   | Dosimali                    |
| Industrial (Light Manufacturing Industry, Service Industry and Medium Industry) Use Zone | Land for Rehabilitation of Slum Dwellers existing on Nala Bank  | Natural Drainage Channel / Waste Water with realignment ( Dhobjore and Tangra Nalas in dotted line - 3 feet deep stone pitching inside and 15 feet wide stone walk way with 50 feet c to c trees / Street lights in developed Urban area) | Trisimali                   |
| Public Semi Public Use Zone  | Old builtup area ( Buildings of historical or architectural or archaeological importance described in the draft C.D.P.Report. ) | Comprehensive Development Plan (SDA) Boundary   | Mustakilchand               |
| Utilities and Services   | Existing Road   | Municipal Boundary  | Railway Pillar/Other Pillar |
| Recreation (and open space) Use Zone   | Proposed Road   | Mouza Boundary  |                             |
| Transportation Use Zone  | Proposed Bridge over River Mahanadi   | Zone Boundary   |                             |
| Special Area Use Zone  | Fly Over Bridge   | Ward Boundary   |                             |
|  |   | Revenue Settlement Boundary   |                             |

**Village Name : Bamaloi**  
**Sheet No.3**

**Tahasil Name : Rengali**

**Source/ Database Used :**  
Data Used For Preparing Existing Landuse  
Satellite Data : World View-1 (PAN)  
Cadastral Data : Year-1980-81  
Ground Truthing : August 2010

**Guideline : Urban GIS Database Development for CDP/ Master Plan Preparation**

Directorate of Town Planning  
Deptt. of Housing & Urban Development  
Govt. of Orissa

**Prepared by :**  
 Gujarat Industrial and Technical Consultancy Organisation, Ahmedabad

Sambalpur Development Authority, Sambalpur