

# PROPOSED LANDUSE MAP

## Sambalpur Development Authority (SDA)

Mouza: Bamaloi; P.S. : Katarbaga No. 31 (8/10)

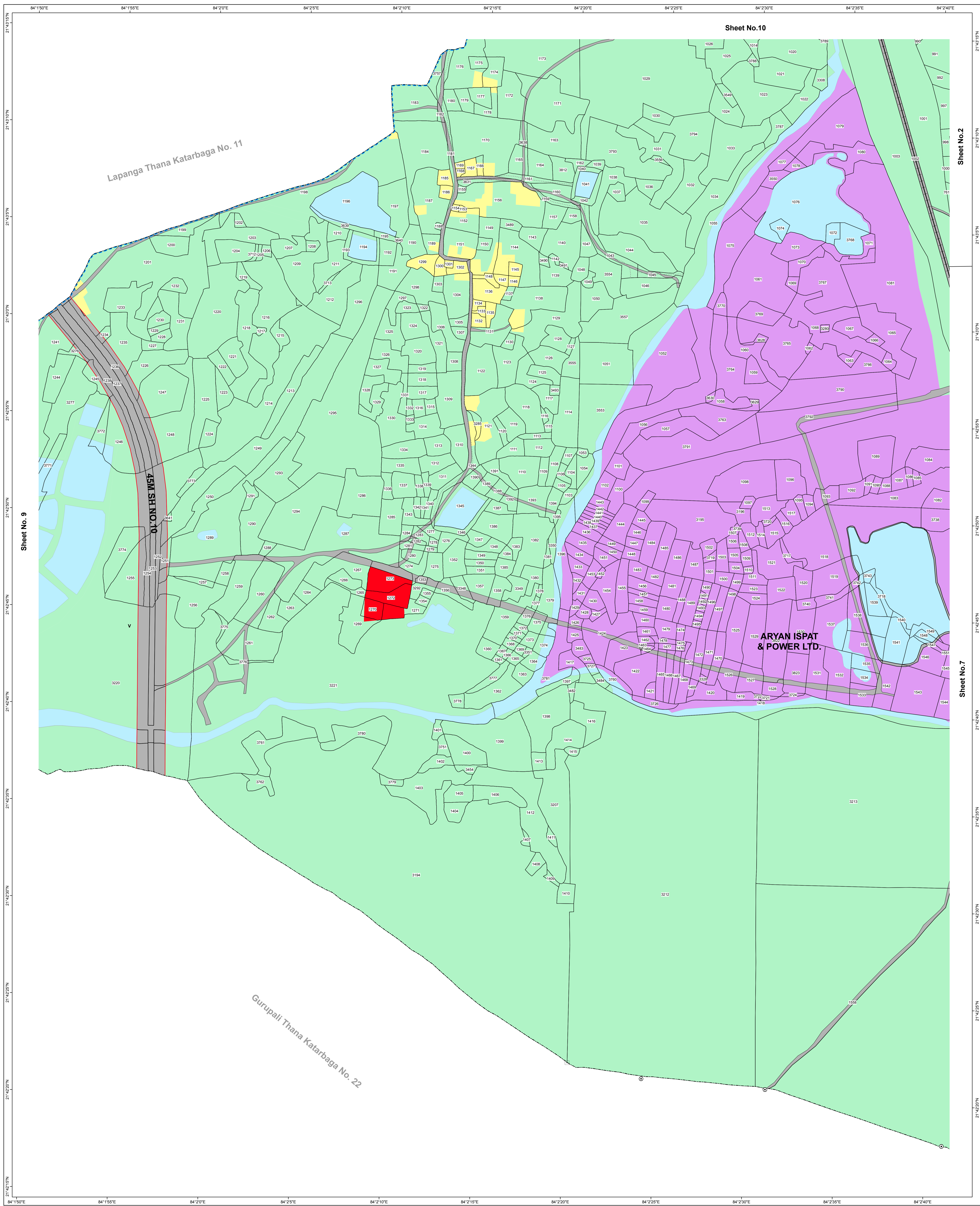
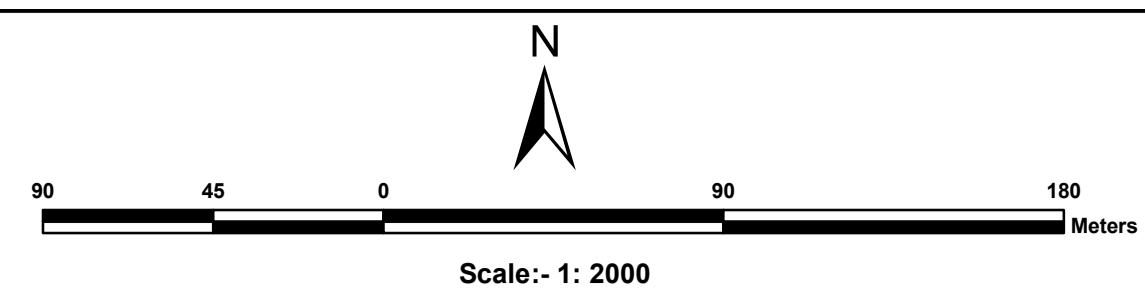

- Residential Use Zone
- Retail Business Neighbourhood Shopping Use Zone
- Wholesale Warehousing and Storage Use Zone
- Industrial (Light Manufacturing Industry, Service Industry and Medium Industry) Use Zone
- Public Semi Public Use Zone
- Utilities and Services
- Recreation (and open space) Use Zone
- Transportation Use Zone
- Special Area Use Zone
- Agricultural (and Allied) Use Zone
- Water bodies Use Zone
- Area : water supply scheme to be introduced in future
- Land for Rehabilitation of Slum Dwellers existing on Nala Bank
- Old builtup area ( Buildings of historical or architectural or archaeological importance described in the draft C.D.P.Report.
- Existing Road
- Proposed Road
- Proposed Bridge over River Mahanadi
- Fly Over Bridge

- Railway Line / Railway Station (RS)
- Existing Water Supply Rising main 1000 mm
- Existing Water Supply Main distribution line 300 mm
- Natural Drainage Channel / Waste Water with realignment ( Dhobjore and Tangra Nalas in dotted line - 3 feet deep stone pitching inside and 15 feet wide stone walk way with 50 feet c to c trees / Street lights in developed Urban area)
- Comprehensive Development Plan (SDA) Boundary
- Municipal Boundary
- Mouza Boundary
- Zone Boundary
- Ward Boundary
- Revenue Settlement Boundary
- Village Road
- Plot Boundary
- Dosimali
- Trisimali
- Mustakilhchand
- Railway Pillar/Other Pillar

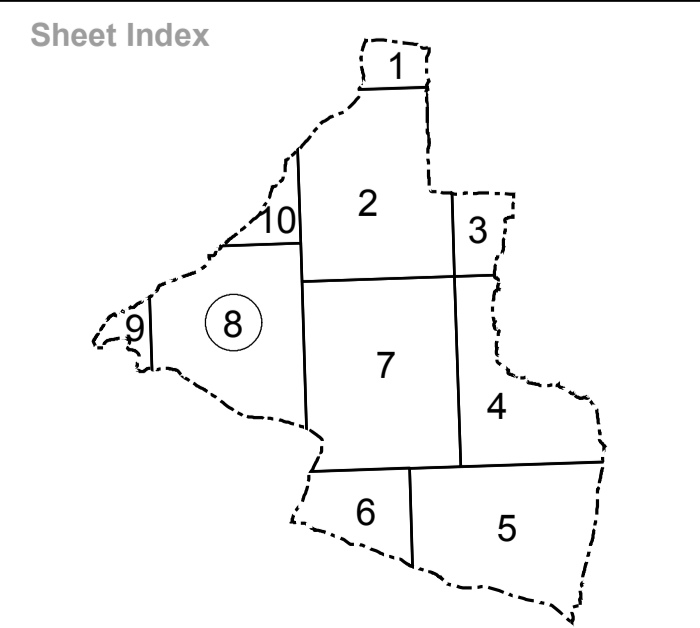

Village Name : Bamaloi  
Sheet No.8

Tahasil Name : Rengali

Source/ Database Used :  
Data Used For Preparing Existing Landuse  
Satellite Data : World View-1 (PAN)  
Cadastral Data : Year-1980-81  
Ground Truthing : August 2010

Guideline :  
Directorate of Town Planning  
Deptt. of Housing & Urban Development  
Govt. of Orissa

Prepared by :  
 Gujarat Industrial and Technical Consultancy Organisation, Ahmedabad

Sambalpur Development Authority, Sambalpur