

PROPOSED LANDUSE MAP
Sambalpur Development Authority (SDA)
 Mouza: Bareipali Sambalpur Town Unit - 13; P.S. : Sambalpur No.14 (3/3)

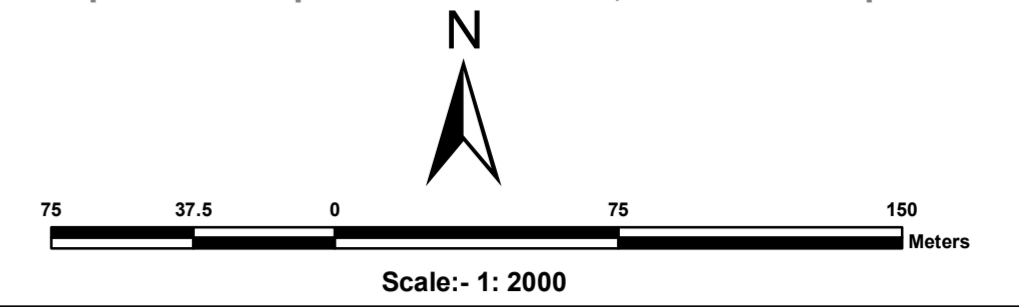

L E G E N D

- Residential Use Zone
- Retail Business Neighbourhood Shopping Use Zone
- Wholesale Warehousing and Storage Use Zone
- Industrial (Light Manufacturing Industry, Service Industry and Medium Industry) Use Zone
- Public Semi Public Use Zone
- Utilities and Services
- Recreation (and open space) Use Zone
- Transportation Use Zone
- Special Area Use Zone
- Agricultural (and Allied) Use Zone
- Water bodies Use Zone
- Area : water supply scheme to be introduced in future
- Land for Rehabilitation of Slum Dwellers existing on Nala Bank
- Old builtup area (Buildings of historical or architectural importance described in the draft C.D.P.Report.)
- Existing Road
- Proposed Road
- Proposed Bridge over River Mahanadi
- Fly Over Bridge
- Railway Line / Railway Station (RS)
- Existing Water Supply Rising main 1000 mm
- Existing Water Supply Main distribution line 300 mm
- Natural Drainage Channel / Waste Water with realignment (Dhobjore and Tangra Nalas in dotted line - 3 feet deep stone pitching inside and 15 feet wide stone walk way with 50 feet c to c trees / Street lights in developed Urban area)
- Comprehensive Development Plan (SDA) Boundary
- Municipal Boundary
- Mouza Boundary
- Zone Boundary
- Ward Boundary
- Revenue Settlement Boundary
- Village Road
- Plot Boundary
- Dosimali
- Trisimali
- Mustakilchand
- Railway Pillar/Other Pillar
- G Government Land

Remed Sambalpur Town Unit No.12
 Thana Sambalpur No.3

Danipali Sambalpur Town Unit No.14
 Thana Sambalpur No.13

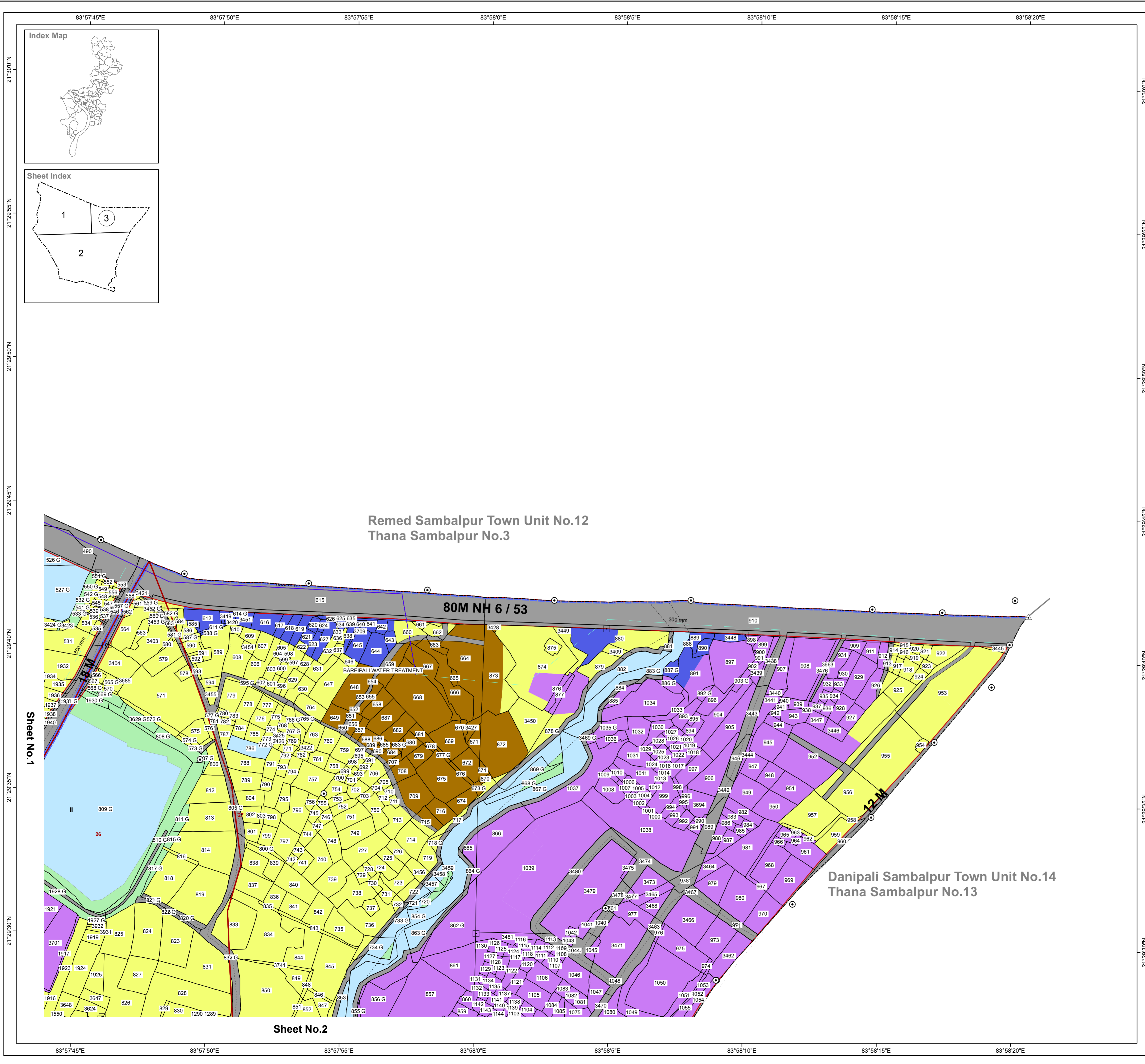
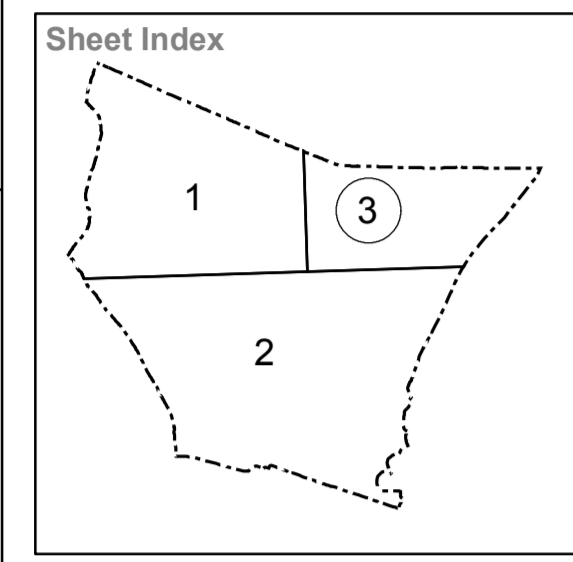
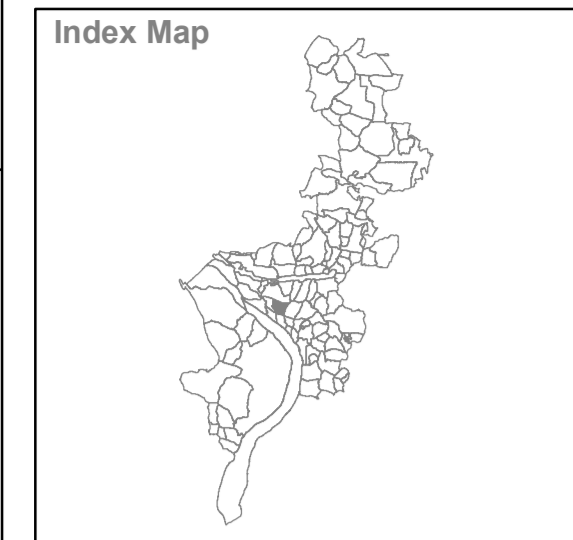

Source/ Database Used :
 Data Used For Preparing Existing Landuse
 Satellite Data : World View-1 (PAN)
 Cadastral Data : Year-1981-82
 Ground Truthing : August 2010

Village Name : Bareipali
Sheet No.3
Tahasil Name : Sambalpur

Guideline : Urban GIS Database Development for CDP/ Master Plan Preparation
 Directorate of Town Planning
 Deptt. of Housing & Urban Development
 Govt. of Orissa

Prepared by :
Gujarat Industrial and Technical Consultancy Organisation, Ahmedabad
Sambalpur Development Authority, Sambalpur